

Mi Window and Door Sensor

Detects Open/Closed Doors or Windows | Smart Linked



*This product must be used in conjunction with a device that provides ZigBee gateway functionality, such as Mi Smart Home Hub.



Senses whether a window/door is open or closed

This window/door sensor includes a main sensor body and a magnet, which work together to determine whether the window/door is open or closed.

Smart connectivity for personalized living

Combine with other Mi Smart Home devices and discover a variety of ways to combine your smart devices. Use your imagination to customize your smart home experience.

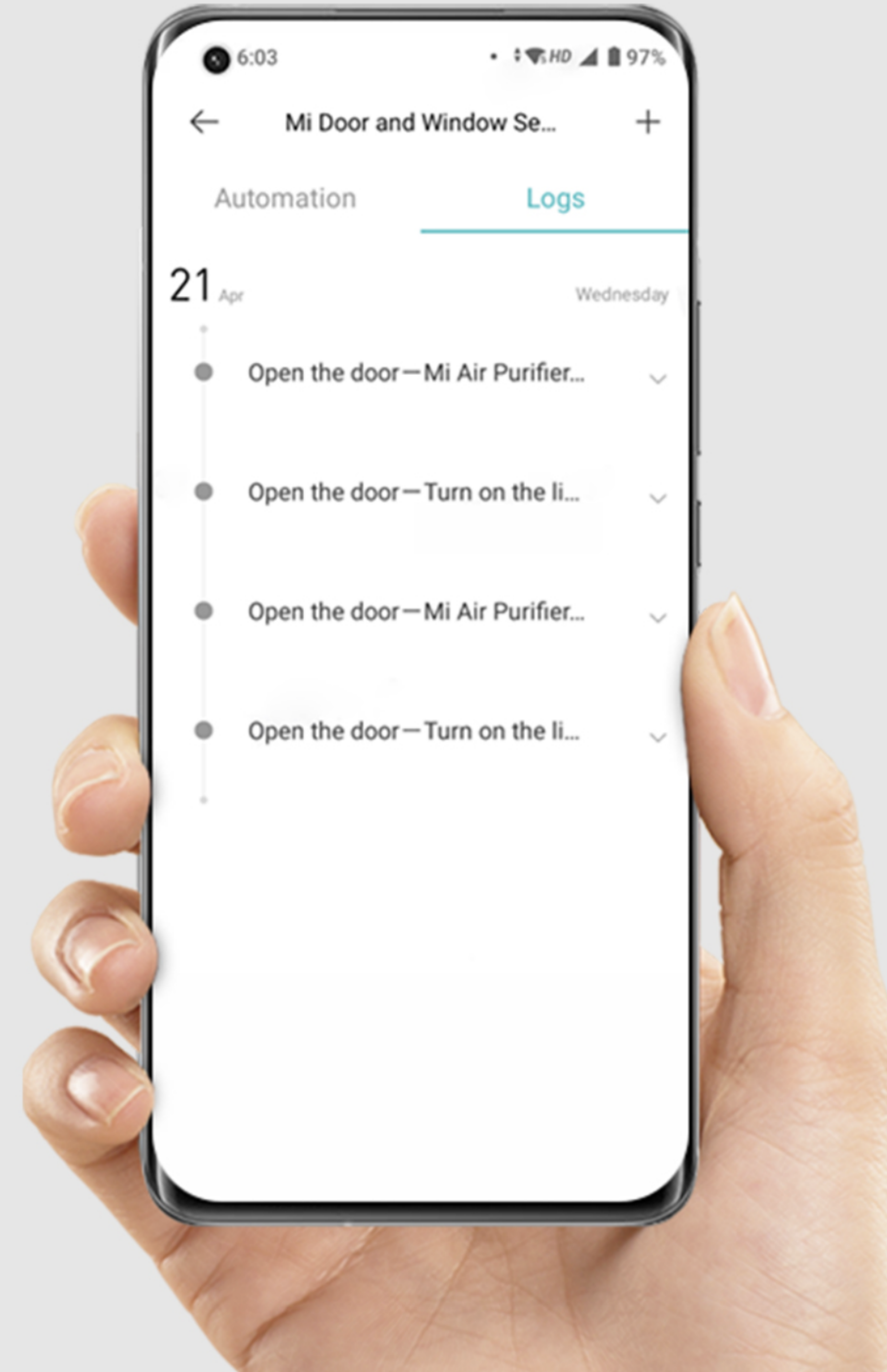

Security protection, monitor remotely

When the Mi Smart Home Hub is in Security Mode, opening the window/door triggers the camera to record a short video and send a push notification to your phone.



Open the door, lights turn on

Open the front door and the living room lights turn on automatically. Let technology take care of it for you.

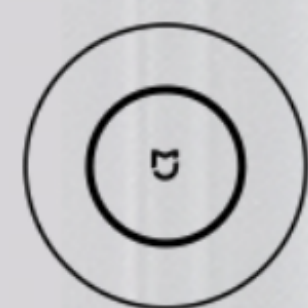

Mi Smart Home Hub

+



Mi Window and Door Sensor

+



Mi Smart LED Ceiling Light





Open the window, air purifier turns off

The air purifier will be turned off automatically when a window is opened for ventilation, saving you both time and energy.



Mi Smart Home Hub

+



Mi Window and Door Sensor

+



Mi Air Purifier

Compact and easy to set up

No need for installation. Just remove the protective film at the back and attach it wherever you like. Won't damage your home doors, windows or furniture. Its compact form saves space.

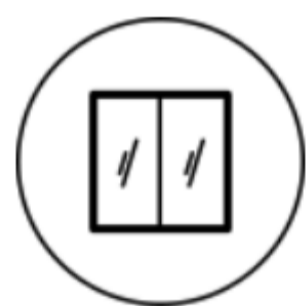

Doors/windows

+

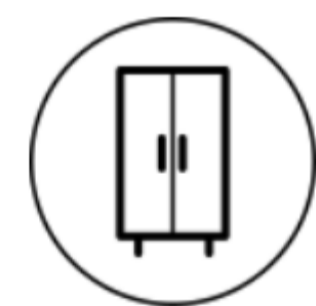

Wardrobes

+



Drawers



Compact yet sophisticated design
Wide range of applications

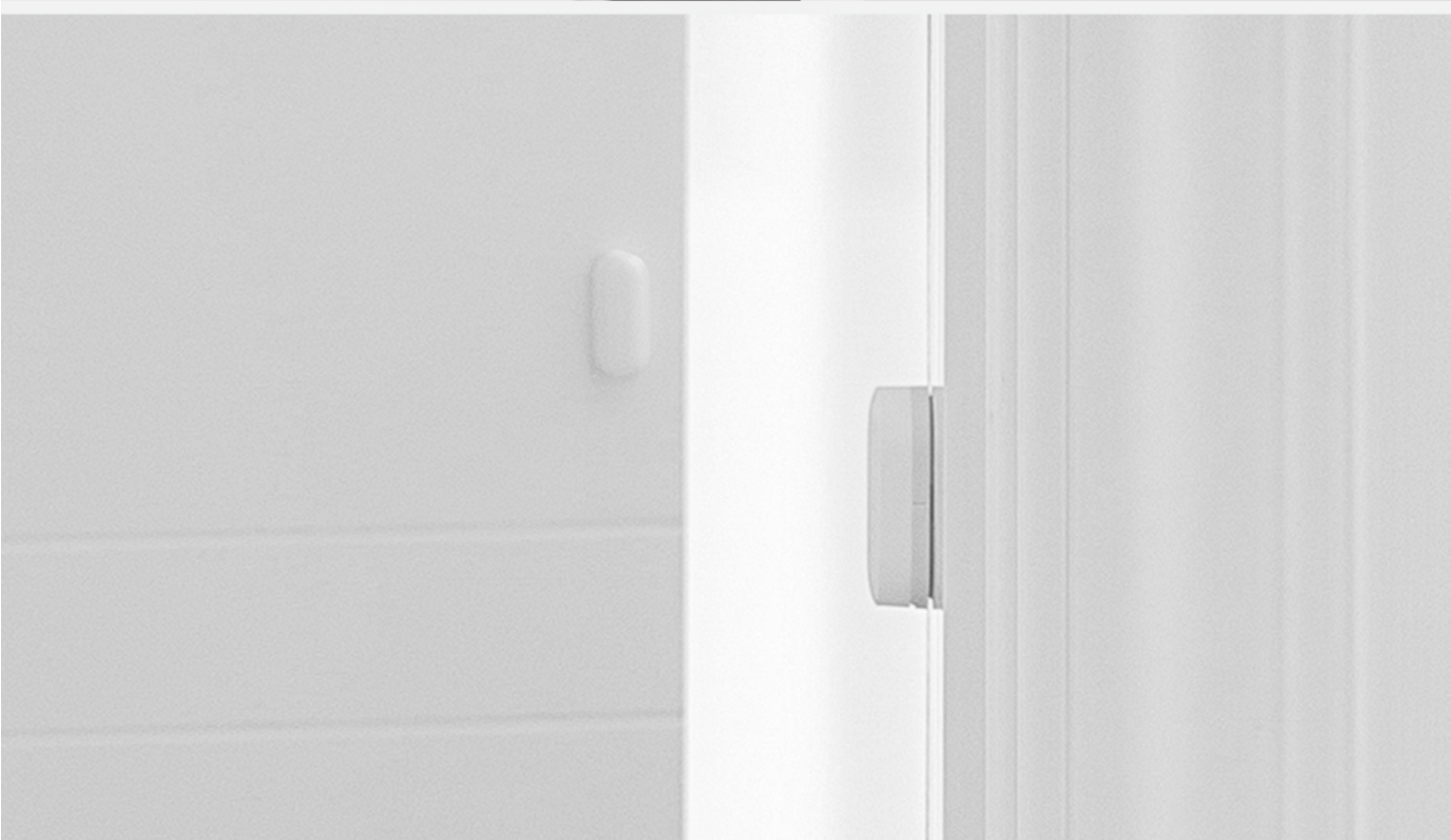

Premium quality and superb craftsmanship

The sensor connects wirelessly to other devices using ZigBee gateway technology, for fast and reliable connectivity.
The batteries can last up to 2 years* under normal conditions.



*The 2-year battery life was confirmed through testing by the Aqara Laboratory. Using standard CR1632 batteries, sensor opening and closing was simulated at a rate of 20 times per day, at an ambient temperature of 25°C. The battery life may vary depending on actual operating conditions. Under low-temperature conditions, battery performance will be reduced and battery life will be shortened.

Easy to install



1. Remove the protective film from the sticker.

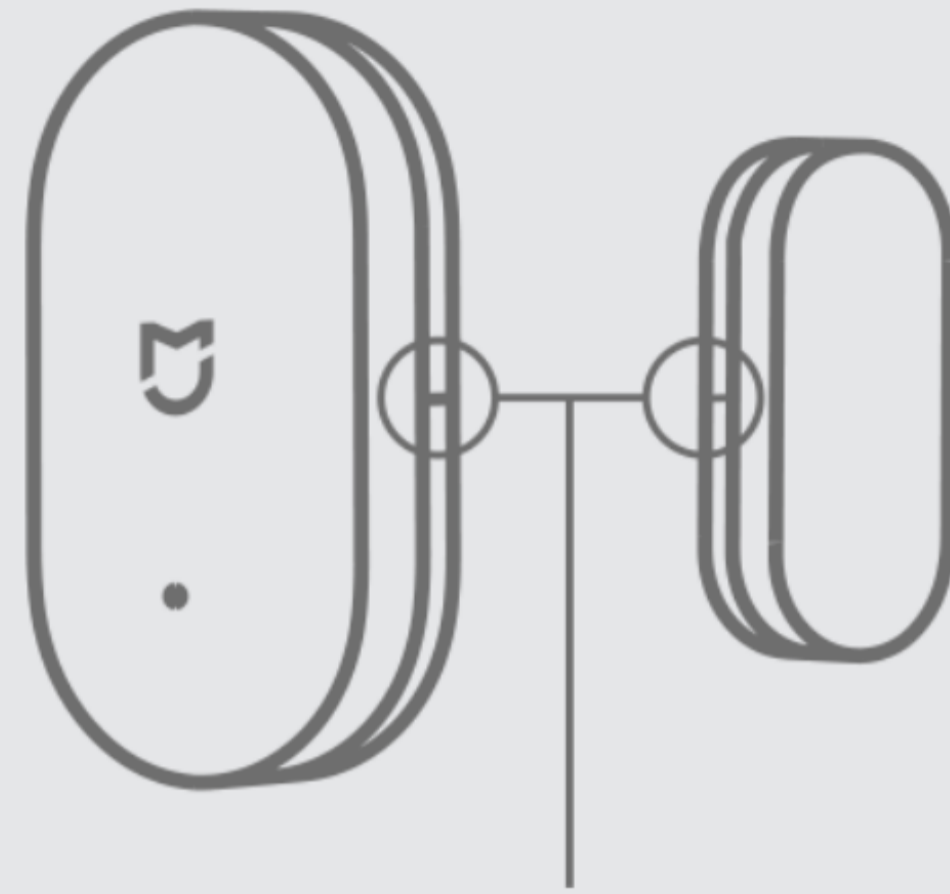

2. Ensure that the installation mark on the side of the main body is aligned with the mark on the side of the magnet.

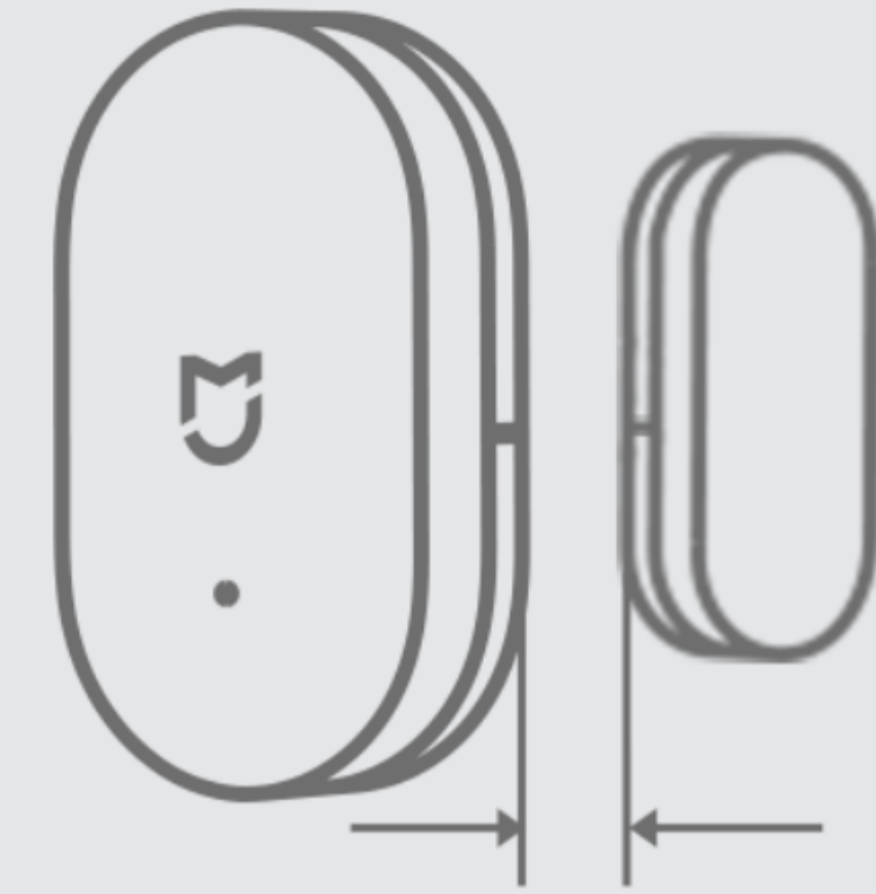

3. Attach the separate parts to the surface where it opens and closes. (The main body should be attached to the fixed surface of the opening/closing area, and the magnet should be attached to the moving surface of the opening/closing area. The gap at the point of installation must be less than 22 mm when the door/window is closed.)

*The adhesive surface must be kept clean and dry. To ensure the stability of wireless signals, do not attach the sensor to metal surfaces.

Quick 3-Step Setup



1. Open the Mi Home app and tap "+" in the top right corner to add the Mi Window and Door Sensor.

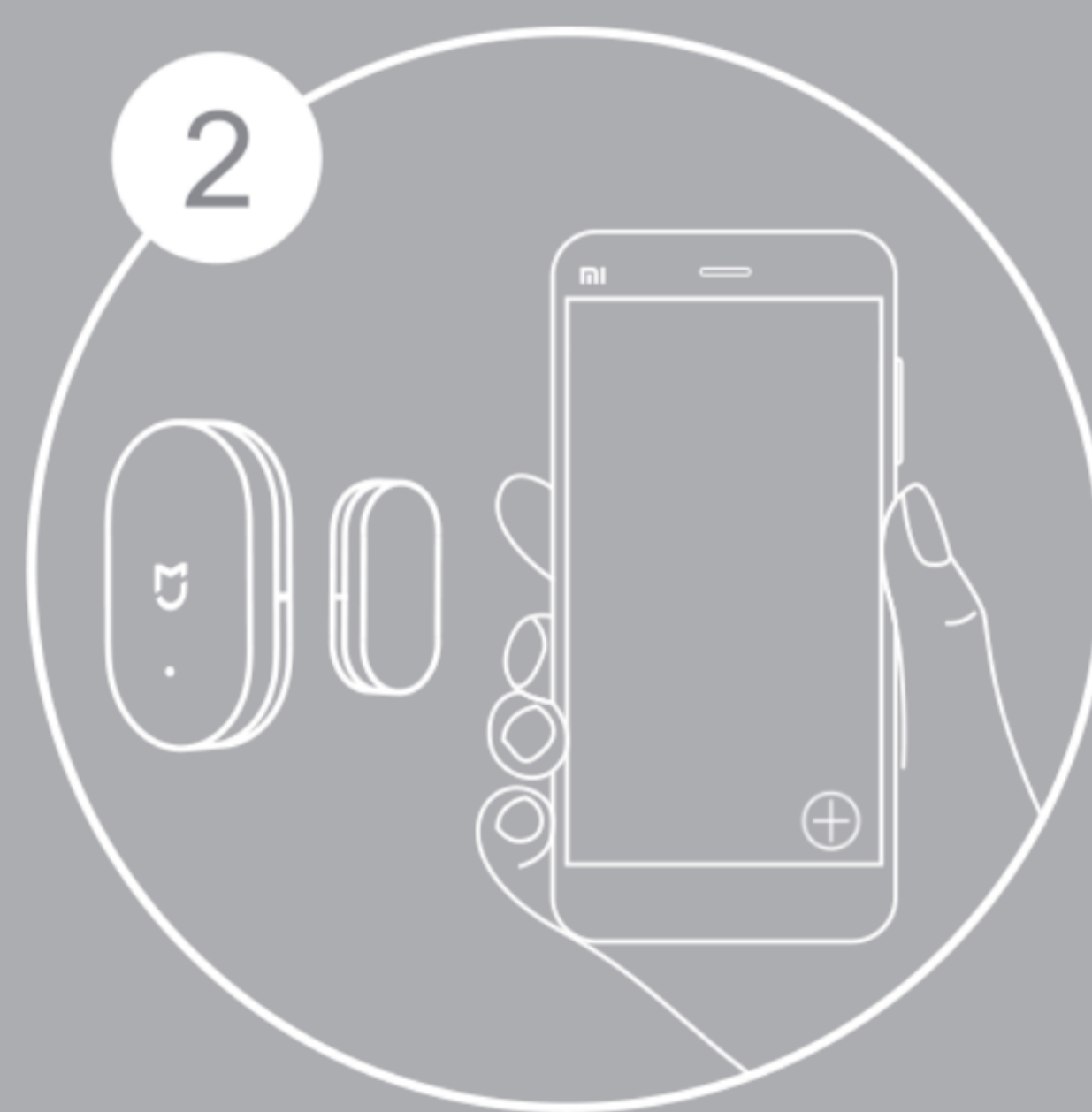

2. Follow the instructions on the page to add the device to the Mi Smart Home Hub.

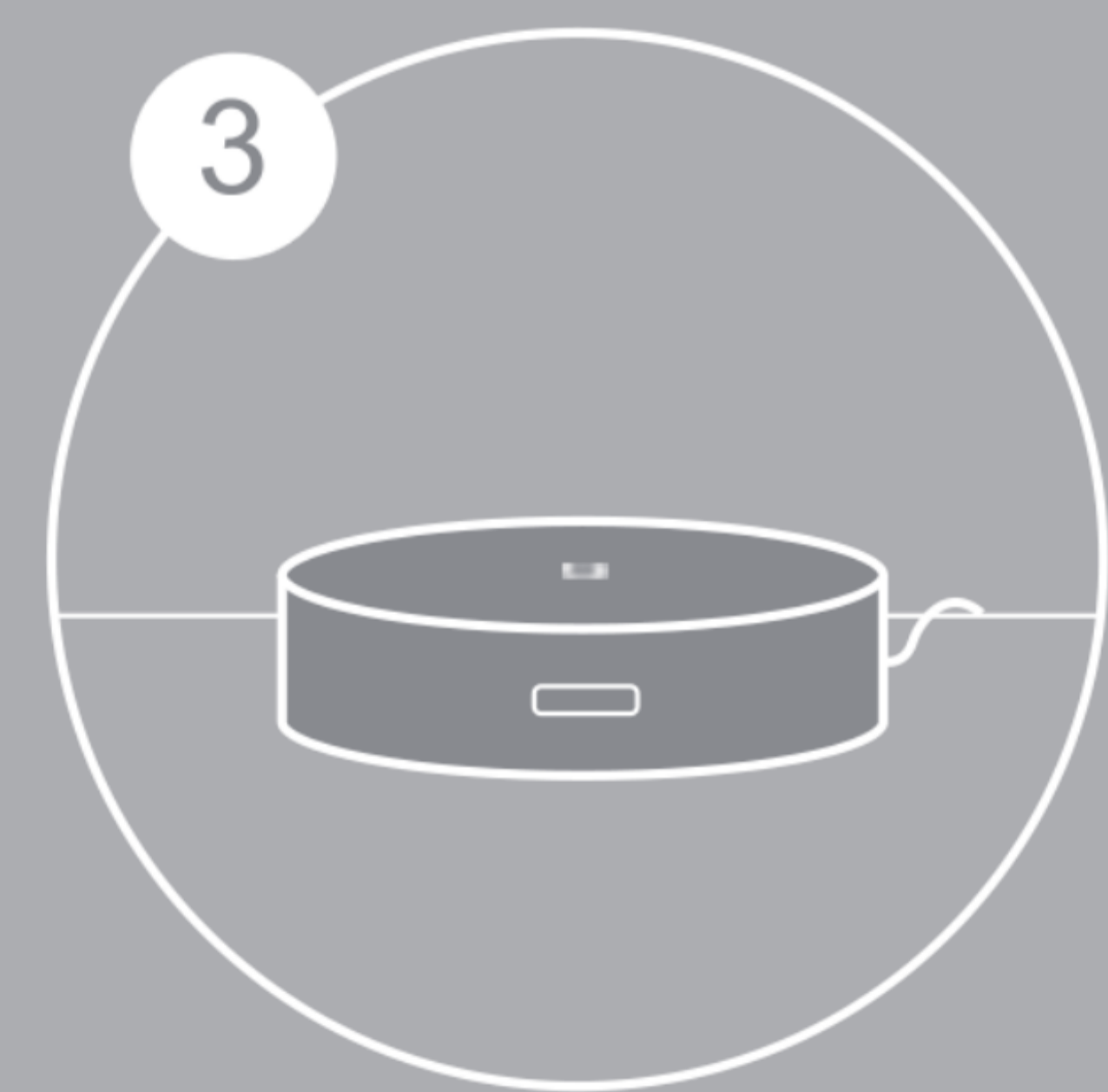

3. The hub will emit two long beeps once the device has been added successfully.